

ALPINE GREENS

246 East Golf Course Road

728



YELLOWSTONE CLUB



INTERIOR RENDERING

- ALPINE GREENS 728 -

246 EAST GOLF COURSE ROAD

Custom Residence 728, located in the Alpine Greens neighborhood of the Yellowstone Club, is tucked into a quiet corner between Hole 4 and Hole 9 on the famed Tom Weiskopf-designed golf course. From this gently-sloped location, the land gracefully dips to reveal impressive views of Lone Peak, Pioneer Mountain, and the Spanish Peaks. Natural beauty abounds in this residence and offers a continual reminder of the grandeur of the surroundings.

With its spacious six bedrooms across three levels, this home offers ample space for extended stays or quick getaways. Gathering spaces are warm and inviting, while bedroom suites are relaxing and private, guaranteeing ease of living. Taking center stage is the home's great room, where peaked windows evoke the feel of the mountain views they capture: these floor-to-ceiling windows blur the distinction between outside and inside and bathe the space in natural light. The expansive wood clad ceilings define the space and lend an air of modernity to the residence.

The home's main level highlights many of the inviting gathering spaces: gourmet kitchen, great room, dining room, and large covered deck complete with outdoor fireplace. This level also includes the master suite, with ample space for quiet relaxation and abundant storage. The home's lower level contains additional guest suites, a bunk room, and laundry facilities. This level also features a fun game nook and cozy recreation area, perfect for movie nights. The lower level opens out to a ground-level patio with fire ring, hot tub, and seating areas. The upper level is home to two additional guest suites, one of which features a private outdoor deck.

The owners of this custom residence will enjoy the numerous amenities that come standard with living in this region of the Yellowstone Club. The Golf Course Clubhouse is a short stroll or drive away, and is the ideal spot for beginning or ending a day on the course. A short drive reveals the boundless amenities of the base area, including dining, shopping, and, of course, renowned skiing opportunities.

- ALPINE GREENS 728 -

246 EAST GOLF COURSE ROAD

FEATURES

.97 Acres

7,510 heated livable sq. ft.

6 bedrooms

7 bathrooms + 1 powder room

Open beam wood clad ceilings

3 stall garage

Weathered barnwood and stone exterior siding

Modern shed roof garage

View of Lone Peak, Pioneer Mountain, Spanish Peaks

Unfurnished

This residence is located within Yellowstone Club, a 15,200 acre private, gated community located in Big Sky, Montana. Yellowstone Club is the world's only private ski and golf community, encompassing thousands of acres of private skiing along with a championship golf course designed by Tom Weiskopf. Additionally, whether looking to savor spectacular mountain panoramas, explore the vast wilderness or enjoy high-quality amenities, Yellowstone Club offers everything from fly fishing, hiking and biking trails to fine dining and spa services. Professional SnowSports, golf and outdoor recreation programs, along with dedicated children's activities, round out the unique Montana experience that is Yellowstone Club.

VIEW OF SPANISH PEAKS

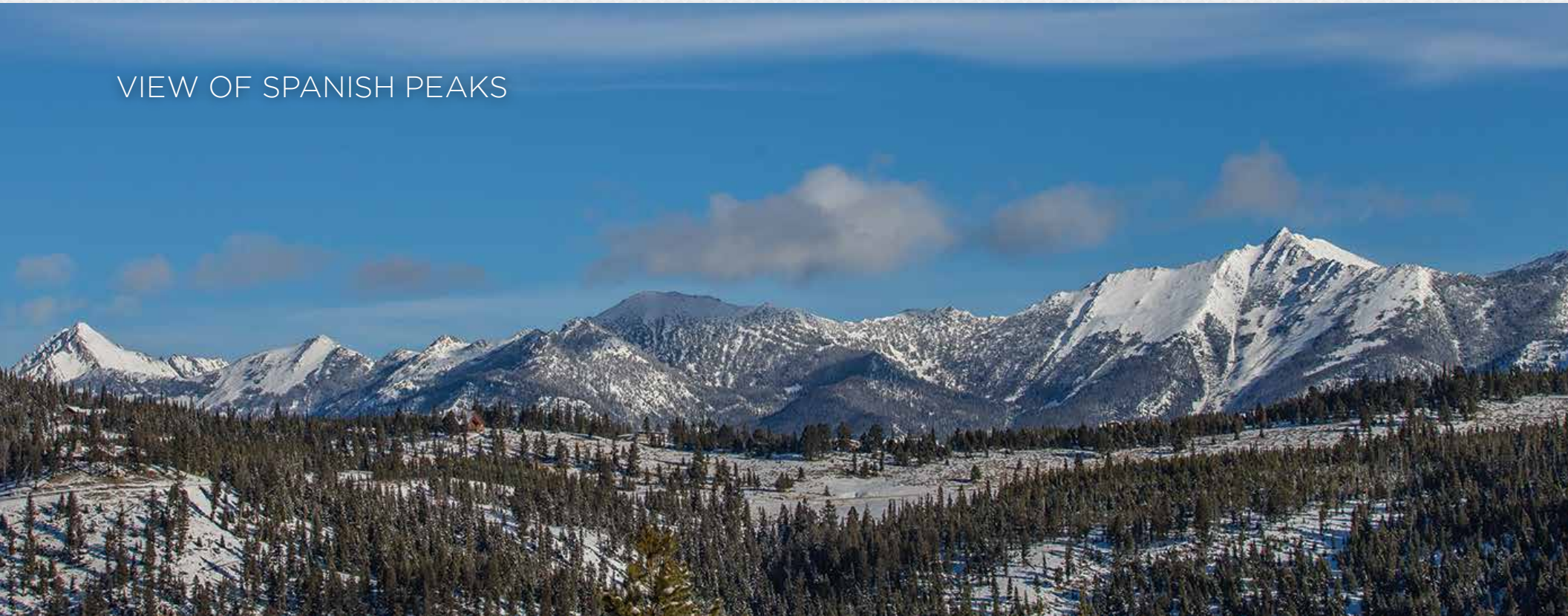

728 SITE PLAN

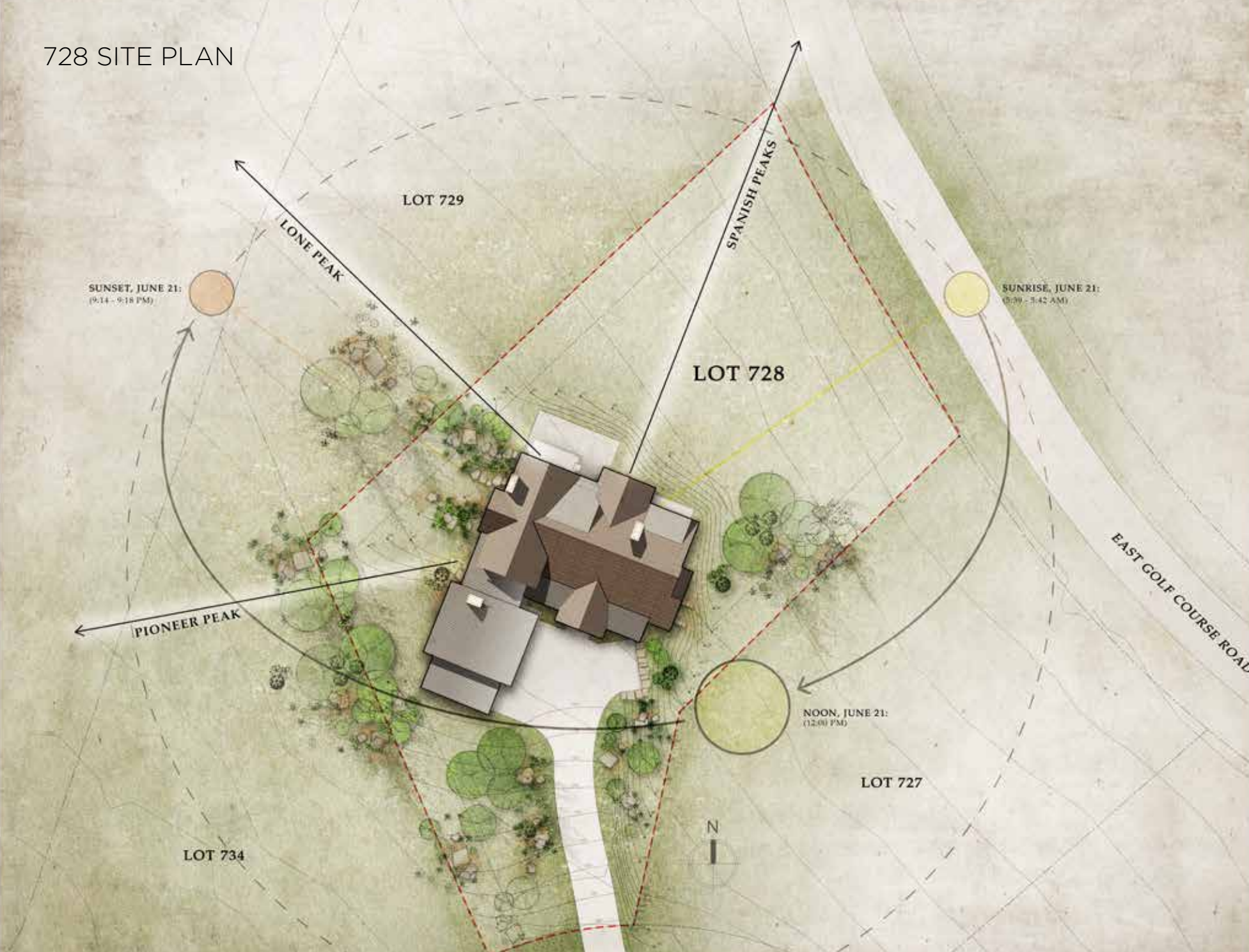

- ALPINE GREENS 728 -

246 EAST GOLF COURSE ROAD



MAIN LEVEL

Rec Room / Game Room / Jr. Master / Bath . Laundry
Guest Suite / Guest Bath / Bunk Room / Bunk Room Bath / Patio



- ALPINE GREENS 728 -

246 EAST GOLF COURSE ROAD

LOWER LEVEL

- Entry / Great Room / Kitchen / Dining / Nook
- Master Suite / Master Bath / Office
- Covered Deck / Laundry / Powder Room
- Storage / Mudroom / 3 Car Garage



- ALPINE GREENS 728 -
246 EAST GOLF COURSE ROAD

UPPER LEVEL
Jr. Master Suite / Bath / Guest Suite / Bath
Deck / Landing

THE VILLAGE & BASE AREA

GONDOLA

EGLISE

ALPINE GREENS NEIGHBORHOOD MAP

0' 200' 500' 1000'



YELLOWSTONE CLUB

11/13/2017



YELLOWSTONE CLUB

For more information about this property and its pricing please contact YC Realty.

(888) 700-7748 | (406) 995-4900 | ycsales@yellowstoneclub.com | P.O. Box 161097 | Big Sky, Montana 59716

www.yellowstoneclub.com

All information deemed reliable, but not guaranteed. All acreages and square footages are estimates. The purchase of a home or homesite does not include membership in Yellowstone Club, or any right to use the private club facilities. Ownership of a home/homesite includes an obligation to pay assessments to a property owner's association. Please ask a sales associate for details. Photographs are representational of the approximate view corridors from the home. Livable square footages listed in this marketing piece are based upon the calculation of only the heated and livable areas within the exterior walls of the property and said square footages are deemed reliable, but not guaranteed. All acreages and square footages are estimates and are provided by the Seller or his designated representative; these measurements should not be a substitute for one's own evaluation and investigation. Ski accessibility is a relative term and can have different implications and meanings depending on the individual. One should investigate fully the property as it relates to its potential ski access and determine for themselves the degree of ski access the property might have or be developed. Buyer acknowledges and agrees that neither the Seller, the Broker, the Sales Associate nor any other real estate representative of the Yellowstone Club or its related affiliates have made any warranties or representations upon which Buyer has relied concerning the ski-in ski-out accessibility of the property. The determination of the level of ski access that a property might have will be the Buyers sole determination. 12/18

