



YELLOWSTONE CLUB

# THE ENCLAVE AT MILLER POINTE



**These residences are located within Yellowstone Club,** a 13,600 acre private, gated community located in Big Sky, Montana. Yellowstone Club is the world's only private ski and golf community, with thousands of acres of private skiing together with a championship golf course designed by Tom Weiskopf.

Additionally, there are fishing streams, hiking and biking trails and horseback riding. Personal attention assures an excellent children's program as well as high-quality amenities which round out the unique Montana experience that is Yellowstone Club.



Master Bedroom



Master Bathroom



Lower Level Rec Room



Bunkroom

## The Enclave at Miller Pointe

The Enclave at Yellowstone Club is a community of artfully crafted townhouses located on Miller Pointe, which is situated halfway up Pioneer Mountain. Miller Pointe is named after the legendary ski filmmaker and YC Honorary Director of Skiing, Warren Miller. Along with immediate proximity to miles of Private Powder skiing on Pioneer, the Enclave's locale offers unmatched access to the Warren Miller Lodge and base area amenities. The Club's Tom Weiskopf-designed 18 hole championship golf course is also mere moments away. Spectacular views of Pioneer, Eglise, Lone Peak, and the Gallatin Range can all be enjoyed from the Enclave.

The Enclave provides a unique opportunity to choose between two styles of finishings – 'Rustic' or 'Arts & Crafts'. Attention to detail in the hand-selected materials and craftsmanship is evident both inside and out. Enclave residents will also enjoy the community's all-inclusive care: each duplex exterior is maintained year-round, sidewalks and driveways are cleared of snow for you in the winter months, and landscaping is beautifully sustained during the summer and fall.

If you and your family are looking for a seamless blend of close proximity, incredible views, and bountiful outdoor activities, The Enclave community provides the perfect mountain retreat.





MAIN LEVEL

B A



LOWER LEVEL

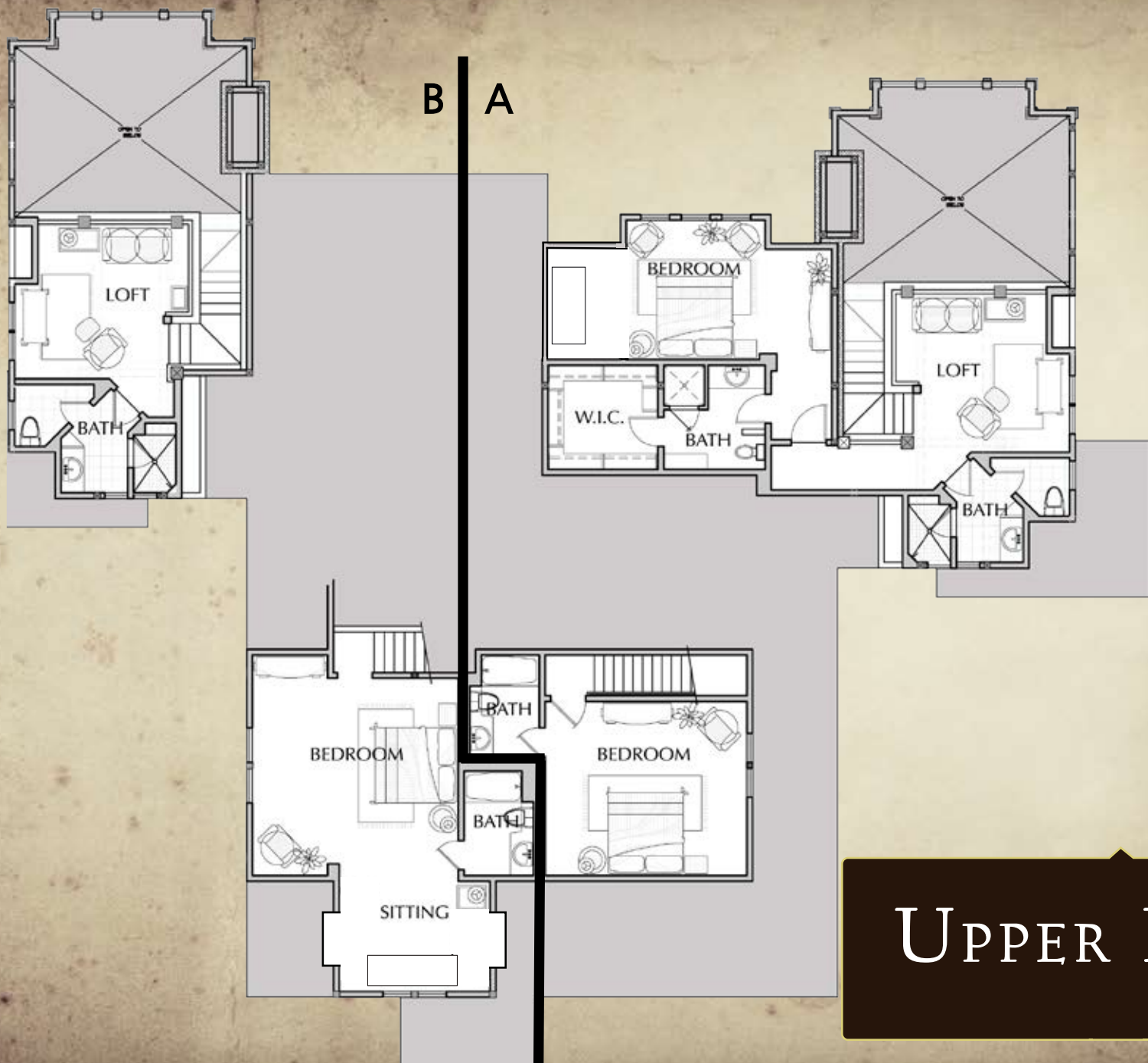

B A

UPPER LEVEL

## FEATURES

- ♦ Mid-mountain location on Pioneer with close proximity to the Warren Miller Lodge, base area, and Rainbow Lodge
- ♦ Multiple living spaces
- ♦ Spacious Kitchen
- ♦ Dedicated laundry room on main level
- ♦ Ski room with lockers and additional laundry equipment
- ♦ Great Room with stone fireplace

### A Units - Rustic Style

Square Footage: 5,012 heated livable sq ft

5,078 heated livable sq ft for units 5 & 6

Bedrooms: 4 + 1 Bunkroom

Baths: 6 + 1 Powder

Garage: 2 Car



- ♦ Rec Room with bar and stone fireplace
- ♦ Extensive exterior living spaces
- ♦ Covered deck off Great Room with exterior fireplace
- ♦ Private deck off Master Bedroom
- ♦ Stone walk-out patios on lower level
- ♦ Lower level patio prepared for hot tub
- ♦ Oversized reclaimed timber columns
- ♦ Ski accessibility from some units

### B Units - Arts & Crafts Style

Square Footage: 4,774 heated livable sq ft

4,806 heated livable sq ft for units 5 & 6

Bedrooms: 3 + 1 Bunkroom

Baths: 5 + 1 Powder

Garage: 2 Car



Entrance

Outdoor Covered Deck



YELLOWSTONE CLUB



Photography by Gordon Gregory & Karl Neumann

## The Enclave at Miller Pointe

Voyager Construction ♦ P.O. Box 161108 ♦ Big Sky, MT 59716 ♦ (406)993-5520

For information regarding pricing, please contact your  
YC Sales Associate from Big Springs Realty, LLC,  
the exclusive broker for Yellowstone Club.

888-700-7748 ♦ 406-995-4900 ♦ P.O. Box 161097 ♦ Big Sky, MT 59716 ♦ [www.yellowstoneclub.com](http://www.yellowstoneclub.com) ♦ [ycesales@yellowstoneclub.com](mailto:ycesales@yellowstoneclub.com)

All information deemed reliable, but not guaranteed. All acreages and square footages are estimates. The purchase of a home or homesite does not include membership in Yellowstone Club, or any right to use the private club facilities. Ownership of a home/homesite includes an obligation to pay assessments to a property owner's association. Please ask sales associates for details. Photographs are representational of the approximate view corridors from the home. Livable square footages listed in this marketing piece are based upon the calculation of only the heated and livable areas within the exterior walls of the property and said square footages are deemed reliable, but not guaranteed. All acreages and square footages are estimates and are provided by the Seller or his designated representative; these measurements should not be a substitute for one's own evaluation and investigation. Ski accessibility is a relative term and can have different implications and meanings depending on the individual. One should investigate fully the property as it relates to its potential ski access and determine for themselves the degree of ski access the property might have or be developed. Buyer acknowledges and agrees that neither the Seller, Big Springs Realty nor any of their agents or employees have made any warranties or representations upon which Buyer has relied concerning the ski-in ski-out accessibility of the property. The determination of the level of ski access that a property might have will be the Buyers sole determination.