

UPDATED FLOOR PLAN PER OWNER'S REVISIONS.

CONDOMINIUM TYPE B FLOOR PLAN GENERAL NOTES

- THIS CONDOMINIUM UNIT IS INTENDED TO BE A TYPE "B" DWELLING UNIT PER BC 2012 SECTION 1107 AND ICC A117.1-2009 CHAPTER 10 INCLUDING AN "OPTION" B' BATHROOM PER SECTION 1904.11.3.2 AS INDICATED ON THE PLAN.
- THIS CONDOMINIUM UNIT IS INTENDED TO COMPLY WITH FHA ACCESSIBLE DESIGN MANUAL, 1998 REQUIREMENTS INCLUDING A "SPECIFICATION" B' BATHROOM AS INDICATED ON THE PLAN.
- ELECTRICAL DEVICES SUCH AS SWITCHES, OUTLETS AND CONTROLS SHALL COMPLY WITH IRC 2012 SECTION 1107.6, ICC A117.1-2009 CHAPTER 10 AND FHA ACCESSIBLE DESIGN MANUAL, 1998 CHAPTER 6.
- PROVIDE REINFORCEMENT AROUND TOILETS, TUBS AND SHOWERS IN ALL BATHROOMS CONTAINED IN THIS CONDOMINIUM UNIT PER BC 2012 SECTION 1107.6, ICC A117.1-2009 CHAPTER 10 AND FHA ACCESSIBLE DESIGN MANUAL, 1998 CHAPTER 6.
- REFER TO SHT. A0.4.2 FOR TYPICAL REQUIRED REINFORCEMENT LOCATIONS U.O.N.
- SEE INTERIOR DESIGN DRAWINGS FOR ALL REQUIRED BACKING SUPPORT FOR F.F.A.E. ITEMS.
- REFER TO SHT. A0.4.1 & A0.4.4 FOR CONDOMINIUM UNIT DOOR TYPES, SCHEDULES, DETAILS AND NOTES.
- ALL DOORS NEXT TO A PARTITION SHALL BE LOCATED 2" FROM PARTITION TYP. U.O.N.
- ALL DOORS APPEARING TO BE CENTERED ON A WALL SHALL BE CENTERED TYP. U.O.N. SEE 1/8" SCALE AREA PLANS FOR ALL EXTERIOR DOORS & WINDOWS.
- DIMENSIONS ARE FROM FACE OF GYP. BD. TO FACE OF GYP. BD. TYP. U.O.N.
- PROVIDE A 1" CLR. AIR SPACE BETWEEN ALL FURRED PARTITIONS AND CORE WALLS AROUND STAIRS AND ELEVATORS. PROVIDE A 1/2" CLR. AIR SPACE BETWEEN ALL OTHER FURRED PARTITIONS AND CONCRETE WALLS TYP. U.O.N.
- PROVIDE ACOUSTICAL UNDERLAYMENT AT ALL HARD FLOORINGS TYP. SEE SPECIFICATIONS SECTION 05 10 20.
- ALL BATH TUBS TO BE MANUFACTURED BY ZUMA COLLECTION. SEE SPECIFICATIONS.
- SEE MASTER BATH FLOOR PLAN 1/A5.03B FOR ALL TYP. BATHROOM DETAILS.
- SEE SCHEDULES FOR ALL RESIDENTIAL APPLIANCES & FP SPECIFICATIONS.
- PROVIDE OVERFLOW FLOOR DRAIN OR LEAK DETECTION DEVICE @ ALL WASHERS TYP.
- PROVIDE UNDER CABINET FIRE EXTINGUISHER IN CODE COMPLIANT LOCATION AS APPROVED BY AHJ.

KEYNOTES

KEYNOTE	DESCRIPTION
C01	STEAM UNIT LOCATION, S.E.D., S.P.D., TYP.
C02	ELECTRICAL SUBPANEL LOCATION, S.E.D.
C03	AUDIO-VISUAL SYSTEM RACK, TYP.
C04	90" X 48" CLEAR FLOOR SPACE, TYP.
C05	FIREPLACE FLUE TERMINATION, S.M.D., SEE EXT. ELEV.
C06	KITCHEN HOOD EXHAUST TERMINATION, S.M.D., SEE EXT. ELEV.
C07	DRYER EXHAUST TERMINATION, S.M.D., SEE EXT. ELEV.
C08	PORTABLE HOT TUB-SPA 7 PERSON "GRANDEE" PER SPEC., S.P.D., S.E.D.
C09	RAISED STONE SLAB HEARTH S.I.D., TYP.
C10	RANGE R-01 & HOOD H-01, SEE SPEC. S.E.D., S.P.D.
C11	RANGE R-02 & HOOD H-02, SEE SPEC. S.E.D., S.P.D.
C12	RANGE R-03 & HOOD H-03, SEE SPEC. S.E.D., S.P.D.
C13	REFRIGERATOR RF-01 & FREEZER RF02, SEE SPEC. S.E.D., S.P.D.
C14	REFRIGERATOR RF-03 & FREEZER RF04, SEE SPEC. S.E.D., S.P.D.
C15	REFRIGERATOR RF-05 & FREEZER RF06, SEE SPEC. S.E.D., S.P.D.
C16	UNDERCOUNTER WINE STORAGE RF-07, SEE SPEC. S.E.D., S.P.D.
C17	UNDERCOUNTER BEVERAGE CENTER RF-08, SEE SPEC. S.E.D., S.P.D.
C17.1	REFRIGERATOR DRAWERS RF-10, SEE SPEC. S.E.D., S.P.D.
C18	UNDERCOUNTER ICE MAKER RF-09, SEE SPEC. S.E.D., S.P.D.
C19	DISHWASHER DW-01, SEE SPEC. S.E.D., S.P.D.
C20	WASHER WD-01, SEE SPEC. S.E.D., S.P.D.
C21	DRYER WD-02, SEE SPEC. S.E.D., S.P.D.
C22	FIREPLACE FP-10, SEE SPEC. S.E.D., S.P.D.
C23	FIREPLACE FP-11, SEE SPEC. S.E.D., S.P.D.
C24	FIREPLACE FP-12, SEE SPEC. S.E.D., S.P.D.
C25	FIREPLACE FP-13, SEE SPEC. S.E.D., S.P.D.
C25.1	FIREPLACE FP-14, SEE SPEC. S.E.D., S.P.D.
C25.2	FIREPLACE FP-15, SEE SPEC. S.E.D., S.P.D.
C25.3	FIREPLACE FP-16, SEE SPEC. S.E.D., S.P.D.
C25.4	FIREPLACE FP-17, SEE SPEC. S.E.D., S.P.D.
C25.5	FIREPLACE FP-18, SEE SPEC. S.E.D., S.P.D.
C26	FIREPLACE FLUE POWER VENT TERMINATION, S.M.D., SEE EXT. ELEV.
C27	PORTABLE HOT TUB-SPA 5 PERSON "ARIA" PER SPEC., S.P.D., S.E.D.
C27.1	PORTABLE HOT TUB-SPA 3 PERSON "JETSETTER" PER SPEC., S.P.D., S.E.D.
C29	ZUMA TUB C7236, SEE SPEC.
C30	ZUMA TUB B7236FS, SEE SPEC.
C31	ZUMA TUB C0636, SEE SPEC.
C32	ZUMA TUB CDF6840, SEE SPEC.
C34	BLU TUB B70105, SEE SPEC.
C35	KOHLER TUB VILLAGER K-719, SEE SPEC.
C35.1	KOHLER TUB TEA-FOR-TWO K-857, SEE SPEC.
C35.2	TOTO TUB FB15650P, SEE SPEC.
C35.3	TOTO TUB ABYSSON, SEE SPEC.
C35.4	OCEANIA TUB NO72FS, SEE SPEC.
C35.5	KOHLER TUB MENDOTA K-605, SEE SPEC.
C35.6	KOHLER TUB MAESTRO K-640, SEE SPEC.
C35.7	KOHLER TUB TEA-FOR-TWO K-863, SEE SPEC.
C35.8	KOHLER TUB BELLWETHER K-647, SEE SPEC.
C38	LIGHTING & SHADE PROCESSOR PANEL, S.L.D. S.E.D.
C37	LIGHTING CONTROL POWER PANEL, S.L.D. S.E.D.
C38	SHADE HEAD END PANEL, S.E.D.

LICENSED ARCHITECT
A. JAMES TINSON
2550
NEW YORK, NY

HART HOWERTON
One Union Street, San Francisco, CA 94111
Tel: 415.439.2300 Fax: 415.439.2301
Email: sh@hartowerton.com

KEY PLAN

YELLOWSTONE CLUB VILLAGE CORE
Big Sky, Montana
USA

DATE: 02/27/2015
ISSUE: 50% CD

DATE: 10/09/2015
ISSUE: PROGRESS

DATE: 03/10/2016
ISSUE: 65% CD

DATE: 04/22/2016
ISSUE: 75% CD

DATE: 06/10/2016
ISSUE: COORD. SET

DATE: 07/08/2016
ISSUE: CONST. SET

REVISIONS

NO.	DATE	ISSUE
1	12/19/16	SI #14
2	1/27/17	SI #15
3	2/28/17	SI #17
4	6/14/17	SI #23
5	6/28/17	SI #24
6	7/20/17	SI #25
7	8/31/17	SI #27
8	10/12/17	SI #29
9	11/21/17	SI #34
10	12/21/17	SI #32
11	4/20/18	SI #33

01 CONDO 2-402 FLOOR PLAN
1/4" = 1'-0"

CONDO KEY PLAN

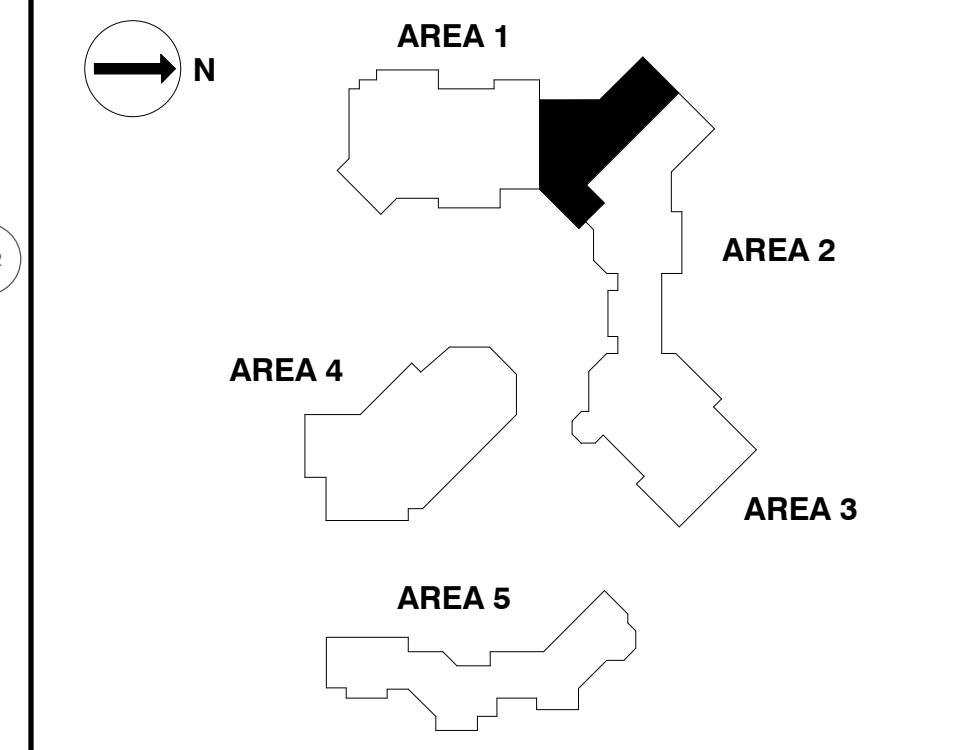

DRAWING TITLE:
CONDO FLOOR PLANS
CONDO #2-402

PROJECT #:
14408

DRAWN BY:
DR. MA. S. B. G.

CHECKED BY:
DEA. J. K.

DRAWING NO.:
A5.14A